

# CCT Dimmable Panel Light



## DESCRIPTION

- Using RF-2.4G high frequency wireless control, lower power, far transmit distance, strong anti-interference capability, high communication rate.
- Stylish appearance, practical function, easily operation.  
Dimming & Color temperature adjustable, synchronous control
- Stepless adjusted CCT & Dimmable, Freely switch between warm white and cool white

## LISTINGS

- CE TUV-GS listed
- P40 Rated-protected from total dust ingress;
- Protected from low-pressure water jets from any direction.

## PERFORMANCE

- Rated lifetime L70: 50,000 hours
- 2700K-6500K
- CR: >80
- Luminous Efficiency: 100lm/W
- Working Voltage: ≤38V

## ELECTRICAL

- Input Voltage: 100-240V AC
- 2.4G CCT dimmable, switch change CCT
- Driver Efficiency: >85%
- Power Factor: >0.9
- THD<15%

## CONSTRUCTION

- Professional circuit design, each group of LEDs work separately
- Wireless Control, easy to use, easy to install
- -20℃~+50℃ operating temperature
- -20℃~ +60℃ storage temperature



**2.4G**

## APPLICATIONS

Hotel	Ballroom
Commercial Purpose	Bar
Distribution Centers	Stage Area
Residential & Institution	

Item	Watts	Lumens	CCT	CRI	DIMMING	INPUT	CE, TUV
GLM-SPL3030-20W-CCT	20W	2000-2200	2700K-6500K	80+	2.4G; Switch Change	100-240V	✓
GLM-SPL3060-20W-CCT	20W	2000-2200	2700K-6500K	80+	2.4G; Switch Change	100-240V	✓
GLM-SPL6060-40W-CCT	40W	3800-4000	2700K-6500K	80+	2.4G; Switch Change	100-240V	✓
GLM-SPL6262-40W-CCT	40W	3800-4000	2700K-6500K	80+	2.4G; Switch Change	100-240V	✓
GLM-SPL30120-40W-CCT	40W	3800-4000	2700K-6500K	80+	2.4G; Switch Change	100-240V	✓
GLM-SPL60120-54W-CCT	54W	4800-5400	2700K-6500K	80+	2.4G; Switch Change	100-240V	✓

## RF-2.4G Lighting System

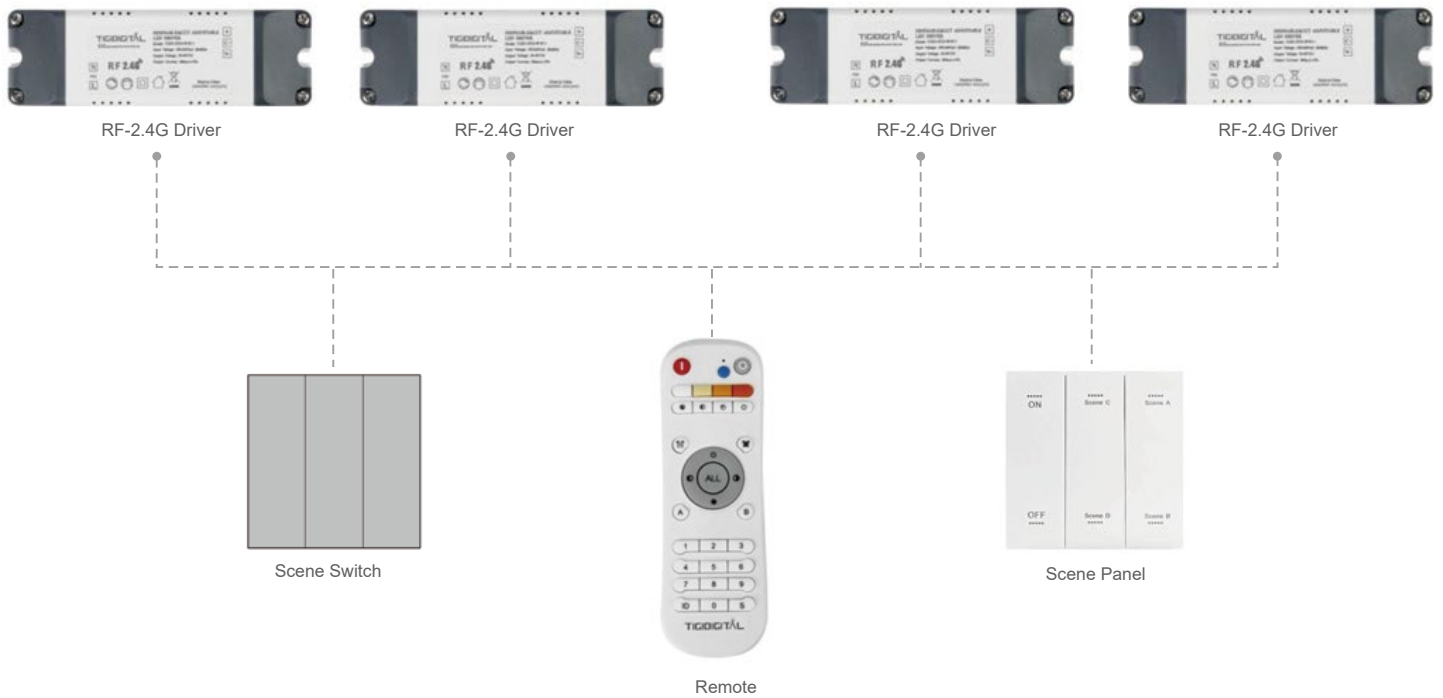

### Remote Controller Parameters

#### Operating method:

##### Steps of Setting ID number of lamps:

- ① Turn OFF the lamp by switch for 3 Seconds, then turn on lamp, finish step ②, ③ within 10 Seconds
- ② Press 1 or 2 numbers on the number keys of remote controller, then press "ID" key
- ③ Repeat step ② again in case of mistake, then the lamp will flash 1 time.
- ④ Turn off the lamp by switch within 10 seconds, then finish setting.

##### Control the lamps:

The function of the keys: as the picture on the right.

Control the single group: press the ID number of the lamp you want to control and then press one functional key (on/off, color temp, brightness).

All-control Model: press "ALL" key to control all groups.

##### TIMING ON/OFF:

Press the ID number of the lamp you want to set, press "ID" key.

SET: Press the number key 1-99, press "⏻" timing ON key or "⏸" timing OFF key, then finish setting. Timing units is 10 minutes.

Cancel: Press "0" key, then "⏻" timing ON key or "⏸" timing OFF key to cancel timing mode.

##### COPY THE ID OF CONTROLLER:

Press "S" key of one controller and "1" key of another controller at the same time, keep 6 seconds, the indicator will flash 3 times, then finish setting.

Recovery: Press the "S" key and "ALL" key of the controller which the ID has been copied for 6 seconds, the indicator will flash 3 times.

##### NIGHT LIGHT MODE:

Press "⚙" key when the lamp is turned off by the controller to enter the night light mode.

##### CIRCLE MODE:

Press the ID of the lamp, then press "⬅️ ➡️ 🔆 🔦" (left, right, up, down) to enter the circle mode.

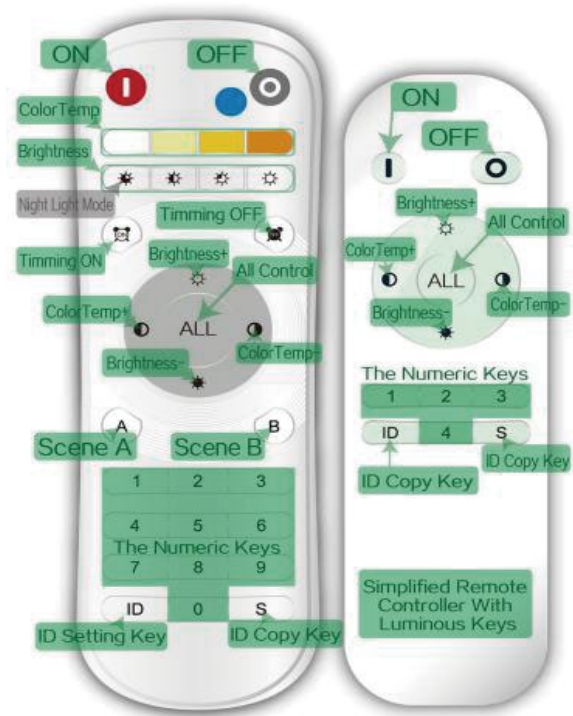

##### SCENE MODE: The system can save two scenes: "A" and "B"

Save:

- ① Adjust the light as your preference.
- ② Press the ID number of the lamp.
- ③ Press "ID" key and then press "A" or "B", the lamp will flash 1 time, then the scene will be saved.

Recall:

- ① Press the ID number of the lamp.
- ② Press "A" or "B", the lamp will enter the scene you preset.